



UB DESIGN STUDIO

ABOUT UB DESIGN STUDIO

At UB DESIGN STUDIO, we believe every project begins with a strong idea — and reaches its true value when that idea is executed with precision.

Our process starts with deep analysis and concept development, shaping a clear design narrative that guides the project from vision to completion. Every stage is handled with intention, coordination, and technical clarity.

An Integrated Approach:

The construction industry often operates in fragmented phases — designers, engineers, and contractors working separately. This separation can lead to inefficiencies, miscommunication, and compromised design integrity.

UB DESIGN STUDIO operates differently. We provide a fully integrated workflow, supporting and collaborating with architecture and interior design firms across the entire project lifecycle — from concept development to execution drawings.

Because we are involved in both design development and visualization, we understand how ideas translate into reality. This allows us to:

- .Design with buildability in mind
- .Anticipate technical challenges early
- .Create photorealistic renderings grounded in real-world execution
- .Protect the original design intent
- .Optimize cost and timeline efficiency

From the first sketch to on-site implementation, UB DESIGN STUDIO ensures continuity, accountability, and excellence. Our Commitment.

We are not just service providers — we are project partners.

We protect the vision, elevate the details, and ensure that what is designed is what gets built.

At UB DESIGN STUDIO, we don't just create and assist in projects. We bring them to life.

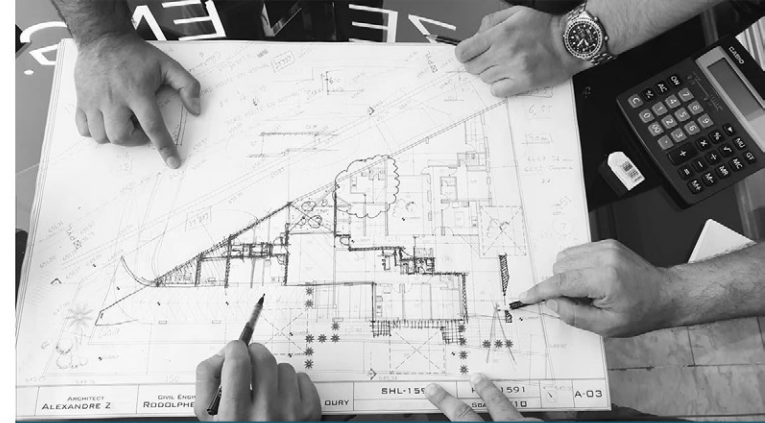

OUR SERVICES

We collaborate with firms by delivering:

Concept & Design Development

3D Modeling & High-End Renderings

Architecture/Interior Design

Full Presentation Packages

Detailed Execution Drawings and Shop Drawings

3D Animation

Technical Coordination



ARCHITECTURE DESIGN

We provide comprehensive architectural design services, transforming ideas into thoughtfully crafted spaces that balance functionality, aesthetics, and technical precision. From concept development to detailed drawings, we ensure every project is tailored, innovative, and execution-ready.



MOOD & SPATIAL STRATEGY

We shape the creative foundation of each project through spatial thinking, mood exploration, and strategic design direction. By studying atmosphere, circulation, proportions, materiality, and user experience, we establish a cohesive vision that guides the project's identity from concept to execution. Our process ensures that every space is visually compelling, functional, and aligned with the client's aspirations.



INTERIOR DESIGN

We offer refined interior design services that transform spaces into elegant, functional environments. From concept and material selection to detailed drawings and styling, we create interiors that reflect identity, enhance comfort, and elevate everyday living.



EXECUTION/SHOP DRAWINGS

We produce meticulous execution drawings and BOQs tailored to each project's requirements. Our team develops fully coordinated, detail-oriented drawing packages across Architectural, Structural, MEP disciplines (execution and shop drawings). Each package incorporates all necessary technical and construction details, ensuring clarity, accuracy, and seamless coordination for efficient on-site execution.



3D RENDERINGS

We produce highly realistic 3D renderings that bring your vision to life with striking clarity and emotion. Through detailed textures, and precise lighting, our visuals capture the true atmosphere of a space—to captivate, and inspire.



3D ANIMATION

We create cinematic 3D animations that transform ideas into immersive visual experiences. Through realistic motion, dynamic camera movements, precise lighting, and carefully crafted details, our animations bring projects to life with clarity and emotion. From architectural walkthroughs to atmospheric storytelling, we deliver visually compelling sequences that communicate design intent, space, and ambiance before construction begins.

MIXED-USE/COMMERCIAL

AQ CENTER

Type: Mixed-Use/Commercial

Location: North East, USA

Size: 16,000 SQF

Year: 2026

Status: In Progress

This project is conceived as a new urban catalyst—an architectural “oxygen” that revitalizes its surroundings and responds directly to the community’s needs. More than a commercial development, the project es-tablishes a social nucleus where people gather, interact, and experience a contemporary lifestyle.

The architecture is defined by bold, dynamic forms and layered planes that create a strong visual identity while maintaining openness and permeability. Generous terraces, shaded outdoor seating, and transparent façades blur the boundary between interior and exterior, encouraging continuous engagement with the public realm. The building’s angular geometry and perforated envelope are carefully designed to control light, provide shading, and enhance comfort, while projecting a forward-looking, futuristic character.

Functionally, the project accommodates a variety of F&B experiences distributed vertically, transforming the building into an active, multi-level destination throughout the day and night. The upper terraces act as elevated urban platforms, of-fering open-air dining and social spaces that overlook the city, while the ground level seamlessly integrates with the pedestrian flow..





COMMERCIAL

Hudson Grove Center

Type: Commercial/Restaurant

Location: New York, NY

Size: 800,000 SQF

Year: 2026

Status: Proposal

Located along the Hudson River in Upper Manhattan, New York City, Hudson Rise Collective redefines the commercial center as a forward-looking urban landmark. Bringing together retail, restaurants, and offices, the project reflects a vision of future New York—dynamic, layered, and deeply connected to its public realm.

The architecture is shaped by intersecting modern volumes that shift and overlap, creating a sculptural presence on the waterfront. Clad in perforated metallic panels, the façade acts as a breathable skin—filtering light by day and emitting a subtle glow by night, adding rhythm and depth to the structure.

A bold cantilevered element extends outward to form a protective canopy over the outdoor plaza, inviting the public into a vibrant common space. At ground level, cafés and retail activate the streetscape, while upper-level offices and restaurant terraces overlook the river and skyline.

Hudson Rise Collective stands as a contemporary civic hub—where architecture, movement, and community converge to shape the next chapter of Upper Manhattan.





COSTA
COFFEE

SUBWAY

STARBUCKS



COSTA

SUBWAY

STARBUCKS

HIGH-RISE

JD-TOWER

Type: High-Rise

Location: Denver, CO

Size: 86,111 Sqf

Year: 2017

Status: Proposal

The JD-Tower is located in the heart of Denver, CO infuses the street with elegance with its appearance symbolizing a very new image for a futuristic city. The tower hosts more than 100 office, corporations and companies that benefit from the amazing views overlooking the silhouette of New York City. In the Ground Floor level arises commercial shops and restaurants. The multi-disciplinary new landmark is welcoming in which workspace, integration, interaction, and commercials can meet in one entity reflecting the beauty of a rising city.





HIGH-RISE/RESIDENTIAL

APEX TOWER

Type: High-Rise/Residential

Location: Brooklyn, NY

Size: 2000,000 SQF

Year: 2026

Status: In Progress

Rising prominently within a bustling district of Brooklyn, Brooklyn Apex Tower establishes a striking new vertical landmark in an area largely defined by mid-rise surroundings. Its singular height and refined silhouette allow it to stand out confidently on the skyline, becoming an architectural focal point within the neighborhood fabric.

The tower's façade is articulated through a sleek combination of ACP panels and expansive glass surfaces, creating a dynamic interplay between solidity and transparency. The metallic cladding introduces a contemporary precision, while floor-to-ceiling glazing maximizes light, views, and a strong connection to the city below.

Integrated strip lighting traces key vertical and horizontal lines of the structure, emphasizing its geometry and giving it a luminous presence after sunset. This subtle illumination enhances the tower's identity at night, reinforcing its role as a beacon within the district.

Designed as a modern residential statement, Brooklyn Apex Tower blends elegance, clarity of form, and urban energy—offering elevated living in a location where its vertical expression truly sets it apart.





HIGH-RISE

ST. MICHEL TOWER

Type: High-Rise/Residential

Location: Montreal, Canada

Size: 53,819 SQF

Year: 2018

Status: Under Construction

Located in a dense and vibrant residential district in Montreal, this 70-meter tower rises as a refined urban oasis, introducing an elegant new landmark within the city's fabric. The ground and first floors activate the public realm through retail spaces, cafés, and offices, while the composition culminates in a luxurious penthouse crowning the rooftop.

The architectural concept explores the expression of an intentionally "unfinished" bold structure. Vertical and horizontal structural elements are extended to their extremities and clad in ACP panels, creating a powerful architectural identity and a distinctive, subtly deviated structural crown.

Greenery is integrated through dynamic slab subtractions, pushing spatial exploitation to its limits and generating movement across the façade. These double-height voids introduce rhythm, depth, and a layered vertical landscape that enhances both visual character and spatial experience.







T.H RESIDENCE

Type: Private House

Location: Pacific Northwest, USA

Size: 10,000 SQF

Year: 2024

Status: Proposal

Located in the lush landscapes of the Pacific Northwest, T.H. Residence is designed as a modern home that harmonizes with its natural surroundings. The architecture blends contemporary design with warm natural materials, creating a welcoming and timeless residential retreat.

The house is characterized by steep sculptural rooflines, vertical timber cladding, and expansive glass façades, allowing natural light to fill the interior while visually connecting the home to the surrounding greenery. Large floor-to-ceiling windows wrap the ground level, creating a transparent living space that opens toward the garden and neighborhood landscape. Inside, the layout emphasizes open living areas and fluid spatial connections, where the living room, dining space, and kitchen form a continuous environment designed for both everyday comfort and social gatherings. The upper level accommodates more private spaces, benefiting from elevated views and a calm atmosphere.

Warm wood textures, soft lighting, and clean architectural lines establish a balance between modern elegance and natural warmth, reflecting the character of contemporary residential design found throughout the region.





HOTEL/LEISURE

MARRIOTT HOTEL

Type: Hotel

Location: Phoenix, AZ

Size: 120,000 SQF

Year: 2021

Status: Proposal

To maximize the number of rooms and suites for a 4-star hotel on a compact site with only two street-facing facades in Phoenix, AZ, the design responds directly to the extreme desert climate, where intense sun and high temperatures require careful control of openings.

The solution is an inner atrium along the south side of the plot, illuminated by carefully sized skylights that filter sunlight. All south-facing rooms benefit from this controlled daylight and enjoy views of a striking 30-meter-tall waterfall wall.

A floating canopy defines a welcoming hotel entrance while activating the public realm: ground-floor retail spaces and shops lead visitors via stairs to the first floor, home to beauty institutes and clinics. A VIP lift connects directly to the tenth-floor restaurant, where adjustable awnings open and close in harmony with the sun, offering diners a comfortable and environmentally responsive experience.





HOTEL/LEISURE

HILTON

Type: Hotel/Leisure

Location: Miami, FL

Size: 90,000 SQF

Year: 2021

Status: Proposal

Located in Miami, FL, the Hilton Hotel rises between two existing buildings, with its design primarily defined by two main elevations exposed to intense sunlight. The concept focuses on creating a façade system that shapes a micro-environment, filtering light and wind to enhance comfort. Movable striped panels reveal outdoor balconies, encouraging guests to enjoy the outdoors during sunset and at night. The minimalist, sculpted design conveys elegant luxury, inviting both visitors and locals to experience the hotel's refined presence.





RESIDENTIAL

Q WEST RESIDENCES

Type: Residential

Location: Istanbul, Turkey

Size: 200,000 SQF

Year: 2026

Status: Proposal

Located in the vibrant borough of Istanbul West Residences rises as a modern expression of elegance and urban sophistication. Designed as a high-level residential address, the building blends contemporary materials and dynamic architectural lines to create a bold yet refined identity within its neighborhood fabric.

The façade is composed of sleek ACP panels balanced with warm natural wood accents, forming a harmonious contrast between precision and texture. Integrated strip lighting traces the building's geometry, enhancing its lively design language and giving it a luminous presence after sunset. The interplay of horizontal and vertical elements creates movement across the elevation, reinforcing a sense of rhythm and architectural clarity.

At street level, curated retail spaces activate the ground floor, contributing to a vibrant pedestrian experience and seamlessly connecting residents to daily conveniences. Above, expansive glazing allows natural light to flood the interiors, offering bright, elegant living spaces that reflect contemporary lifestyles. Q West Residences is conceived as more than a residential building—it is a statement of modern living, where refined materials, thoughtful detailing, and mixed-use energy come together to shape a sophisticated urban home.





GG RESTAURANT

Type: Commercial

Location: Southeast Coast, USA

Size: 20 000 SQF

Year: 2025

Status: Proposal

Located along the southeast coast of the United States, Glass Grove is envisioned as a contemporary dining pavilion where architecture connects seamlessly with its surroundings. The restaurant is designed as a transparent glass volume, creating a light and open structure that visually links the interior dining spaces with the landscape.

Defined by clean horizontal lines and floor-to-ceiling glazing, the building presents a refined yet welcoming presence along the street. During the day, the glass reflects the surrounding greenery, while at night warm interior lighting transforms the restaurant into a glowing urban landmark.

Framed by palm trees and layered planting, the landscape softens the modern architecture and creates a calm garden setting. Inside, the restaurant unfolds across two levels of open dining spaces, offering views of the surrounding greenery and city life. With a minimal palette of glass, steel, warm lighting, and vegetation, Glass Grove becomes a place where dining, architecture, and nature meet.





C.C. STORE

Type: Commercial

Location: Northeast, USA

Size: 50,000 SQF

Year: 2025

Status: Proposal

Within the dynamic urban fabric of the Northeast United States, the C.C. Store is envisioned as a contemporary retail destination that reflects clarity, transparency, and modern urban commerce. The building is defined by its clean geometric form, expansive glass façades, and strong vertical and horizontal framing, creating a balanced architectural composition. Large floor-to-ceiling glazing allows natural light to penetrate deep into the interior while visually connecting the retail spaces with the surrounding city streets.

At the ground level, the transparent façade strengthens the store's relationship with the public realm, creating an inviting and active street presence that naturally draws pedestrians inside. The interior is organized to accommodate flexible retail displays and open circulation, allowing products to be showcased clearly while providing a comfortable shopping experience.

Through the use of glass, metal panels, and refined lighting, the project establishes a contemporary architectural identity while contributing to the evolving character of modern urban shopping districts.





L.C. BUSINESS CENTER

Type: Commercial

Location: West Coast, USA

Size: 100,000 SQF

Year: 2026

Status: Proposal

Located within the vibrant urban environment of the West Coast of the United States, L.C. Business Center is envisioned as a contemporary commercial building that reflects openness, innovation, and modern city life.

The architecture is defined by sleek horizontal lines, expansive glass façades, and refined metal cladding, creating a strong yet elegant presence within the urban streetscape. Large floor-to-ceiling windows allow natural light to flow throughout the interior spaces while establishing a strong visual connection between the building and the surrounding city.

The ground level features a transparent and welcoming street interface, encouraging interaction with the public realm and activating the surrounding sidewalks. Upper levels accommodate flexible office and collaborative workspaces designed to support productivity, creativity, and comfort.

Through a balanced palette of glass, metal panels, warm lighting, and integrated landscaping, the project expresses a contemporary architectural identity while contributing to the evolving character of modern West Coast business districts.





K.C CROSSRAIL

Type Public Space

Location: Kuwait City, Kuwait

Size: 70,000 SQF

Year: 2015

Status: Proposal

Since the advent of oil modernization in 1950, Kuwait city tackled an urban transformation and development that had impact on the urban society, social relations and public behavior, including the demolition of one of the oldest government hospitals "Al-Amiri Hospital" in the late 1970's to become today a parking lot that serves the area.

The project's mission is to revitalize the place that used to be the public's destination for medical services without mislaying its actual function and denying its past. In order to conserve the land's initial function that seem to be a parking lot, the whole structure is shifted all the way to the underground, leaving the ground level freely open to the vibrant city.

The proposition is to re-create the initial facade considered to be the symbiosis screen that will connect the past to the future. Thus, its duty is to project us to the future performing an architectural contrast where behind the aesthetical arches blends a stylistic plant that renew itself referring to the theory that nature that corrects human's mistakes.

Hence, the public umbrella is a cell-based and self-iterating shape with 70% of the plot open to the sky allowing the smooth penetration of the sun rays to the inside of the public cross rail.

In an act of covering the pedestrian alleyways from one part and allowing the photo-synthesis procedure to ensue in the green areas from another part will provide a natural environment to the gathering public.

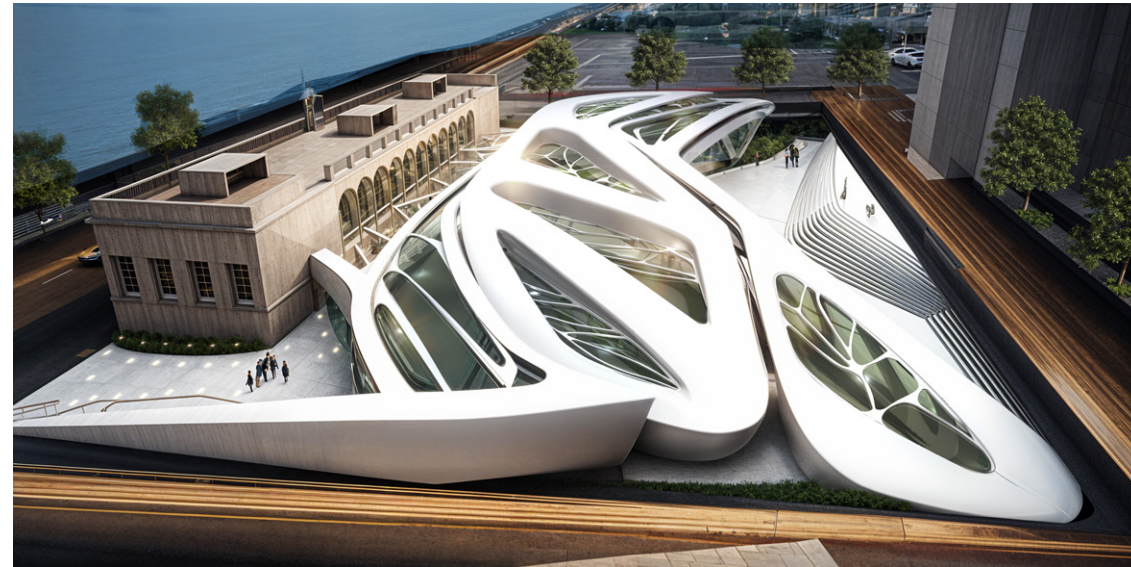



AL-MADDAN CENTER

Type: Commercial

Location: Jeddah, KSA

Size: 75,347 SQF

Year: 2017

Status: Idea

The building is an oasis that will combine the benefits of space, air and greenery. Sustainability is the key criteria that the building pursuit. The sequence of spaces is orchestrated as a stairway that reflects the building's geo-metry, in a way that the form follow the functions that reacts to it. In the ground floor, the exhibition hall and the offices emerges while in the upper floors we have a mix of offices and dormitory. A slight straight translation on each level of the building towards the plot's outskirts to generate green spaces as a canopy to the extreme tropical weather of KSA. The façade is a translucent curtain that conserve 60 % of the intensive solar rays leaving the interior spaces comfortable and viable.





COMMERCIAL

S. SQUARE

Type: Commercial/Retails

Location: Bodrum, Turkey

Size: 7534 SQF

Year: 2016

Status: Under Construction

Located in a prominent area of Bodrum, where a retail hub in such a key location plays a vital role. The design of the center is split into two distinct volumes connected by a bridge tunnel, enabling fluid circulation across two-story retail units. Both twin structures are conceived with an expressive and dynamic form to attract shoppers and establish an urban landmark within cityscapes.

Inspired by the organic shape of a leaf, the main façade features layered titanium-zinc panels seamlessly integrated with the roof, sheltering the spider-glass storefronts below and creating a striking, contemporary aesthetic that resonates with Seattle's architectural character.



PALM HAVEN RESIDENCES

Type: Residential

Location: Dubai, UAE

Size: 450,000 SQF

Year: 2023

Status: Proposal

Set within a lush, master-planned enclave in Dubai, this contemporary residential development is conceived as a refined urban oasis that balances density with tranquility. The project is organized as a series of mid-rise buildings arranged around a central landscaped courtyard, creating a strong sense of community while maintaining privacy for residents.

The architecture is defined by clean geometries, warm neutral tones, and expansive glazing, reflecting a modern aesthetic suited to Dubai's evolving residential landscape. Generous terraces, rooftop amenities, and carefully articulated façades provide depth and shading, responding to the region's climate while enhancing the visual identity of the development.

At the heart of the project, a resort-style pool and lush greenery form a serene communal core, offering residents a retreat from the surrounding city. Pedestrian-friendly pathways, integrated landscaping, and a clear circulation hierarchy reinforce a seamless living experience. The overall composition combines contemporary design with resort-inspired living, creating a vibrant yet آرام residential environment in the heart of Dubai.





V HOUSE INTERIOR

Type: Private Mansion

Location: LI, New York

Size: 20,000 SQF

Year: 2023

Status: Under Construction

This interior design project envisions a sophisticated residence for a young American billionaire, showcasing a modern, luxurious lifestyle. The space is defined by the opulence of high-quality marble, meticulously crafted into futuristic compositions that create a sense of continuity and openness. The marble seamlessly dialogues with pristine white ceilings and minimalist walls, offering a balanced contrast that enhances the mansion's grandeur.

Warm, luxurious wood tones add depth to the interiors, blending inclusively with the marble finishes to create an inviting, contemporary aesthetic. The choice of Minotti furniture complements this style impeccably, further elevating the refined atmosphere. Grand chandeliers, suspended 10 feet down, cast a dramatic glow over the rooms, enhancing the mansion's modern elegance.

A signature feature of the mansion, the staircase, exemplifies resilience and innovation, with each floating step intricately connected by marble verticals. This unique design echoes the strength and ambition of the young entrepreneur, while also contributing to the seamless flow of the interior space.









INTERIOR

MALATINO HOUSE

Type: Interior Design

Location: Port Washington, NY

Size: 1000 SQF

Year: 2024

Status: Proposal

Located in Port Washington, New York, this is a house renovation design for the superintendent of the village of Old Westbury. It is conceived to become more tailored to his current lifestyle as a grandfather and a father to a prominent family in a modest, small space and to accommodate the adequate compact space for living, cooking, playing, and dining. The interior design is a pure American continuity prominently enhanced to resemble the period of our time and to the clean, neat, minimalist style the tenants aspire to. Thus, the light open colors prevail through the light wooden textures, and the pure white perfectly blends with the elegant minimalist furniture. The potential of this design is the ability to generate more with less. Yet, small design gestures were generated with little, creating a lively space that would gather a whole family to live a peaceful, quiet life and simultaneously with a modernistic future feel.





COMMERCIAL

MEDIX HQ

Type: Offices/Interior

Location: Northeast,USA

Size: 35,000 SQF

Year: 2022

Status: Completed

Then **MEDIX** office is designed as a futuristic, tech-integrated workspace for 500+ employees, balancing comfort, productivity, and creativity. It features an open, flexible layout with modular furniture and distinct zones for focus, collaboration, meetings, and relaxation. Smart systems will manage lighting, climate, and acoustics, while interactive tools and sustainable high-tech materials enhance efficiency and aesthetics. Biophilic design elements, such as greenery and natural materials, improve well-being and reduce stress. The design reflects the company's innovative brand identity, resulting in a dynamic, adaptable environment that nurtures collaboration, individual focus, and long-term productivity.





INTERIOR

SB FLAT

Type: Interior Design

Location: Los Angeles, CA

Size: 1000 SQF

Year: 2024

Status: Completed

Overlooking the breathtaking West coast sea views, the SB apartment embodies a seamless blend of modern luxury and refined elegance, tailored for a client who values sophistication and forward-thinking design. The interior unfolds as a harmonious composition of rich, high-end materials—luxurious marble and refined walnut wood—accentuating both beauty and function. Carefully selected, state-of-the-art furniture and fixtures elevate the space, creating a timeless ambiance that speaks to the client's business acumen and high standards. Every element has been thoughtfully orchestrated to establish a futuristic yet warmly inviting aesthetic, where the contemporary lifestyle meets the essence of opulence.





COMMERCIAL

FURN BEAINO CAFE DUBAI

Type: Commercial/Restaurant

Location: Dubai, UAE

Size: 2100 SQF

Year: 2026

Status: Under Construction

Inspired by the refined identity of Furn Beaino, this café project in Dubai brings the brand's warm hospitality to life through carefully selected architectural elements and materiality.

The design highlights the arch as a recurring visual motif, reinterpreted at different scales throughout the interior. These arches are expressed through elegant oak-wood textures, introducing warmth and sophistication to the space. One of the signature features is a vertical greenery installation framed within a sculptural metal structure, where plants rise dramatically and are accentuated with subtle linear LED lighting to create an atmospheric glow.

Terrazzo flooring was selected for its timeless character and its harmony with the café's burgundy-toned furniture and banquet seating—colors that form an essential part of Furn Beaino's visual identity. The façade adopts a minimal yet striking approach, clad in sleek black ACP panels that elegantly display the brand's signage. A discreet service door ensures smooth operations, while the outdoor seating area is framed with black metal planters to create a welcoming urban terrace.

The overall ambiance is modern and elegant, designed to elevate the dining experience while maintaining a relaxed atmosphere. In addition to the main seating area, the layout includes a private space suitable for business meetings, allowing guests to enjoy both casual gatherings and professional encounters within the refined environment of Furn Beaino.





UB DESIGN STUDIO

CONTACT:

PHONE:

+1 (929) 341 1758 ext: 554 +1 (516) 460 4572

E_MAIL:

alex@ubdesignstudio.com

ADDRESS:

565 Broadhollow Rd
Farmingdale, NY 11735



UB DESIGN STUDIO